

## Sports Side Bags X0 SB44

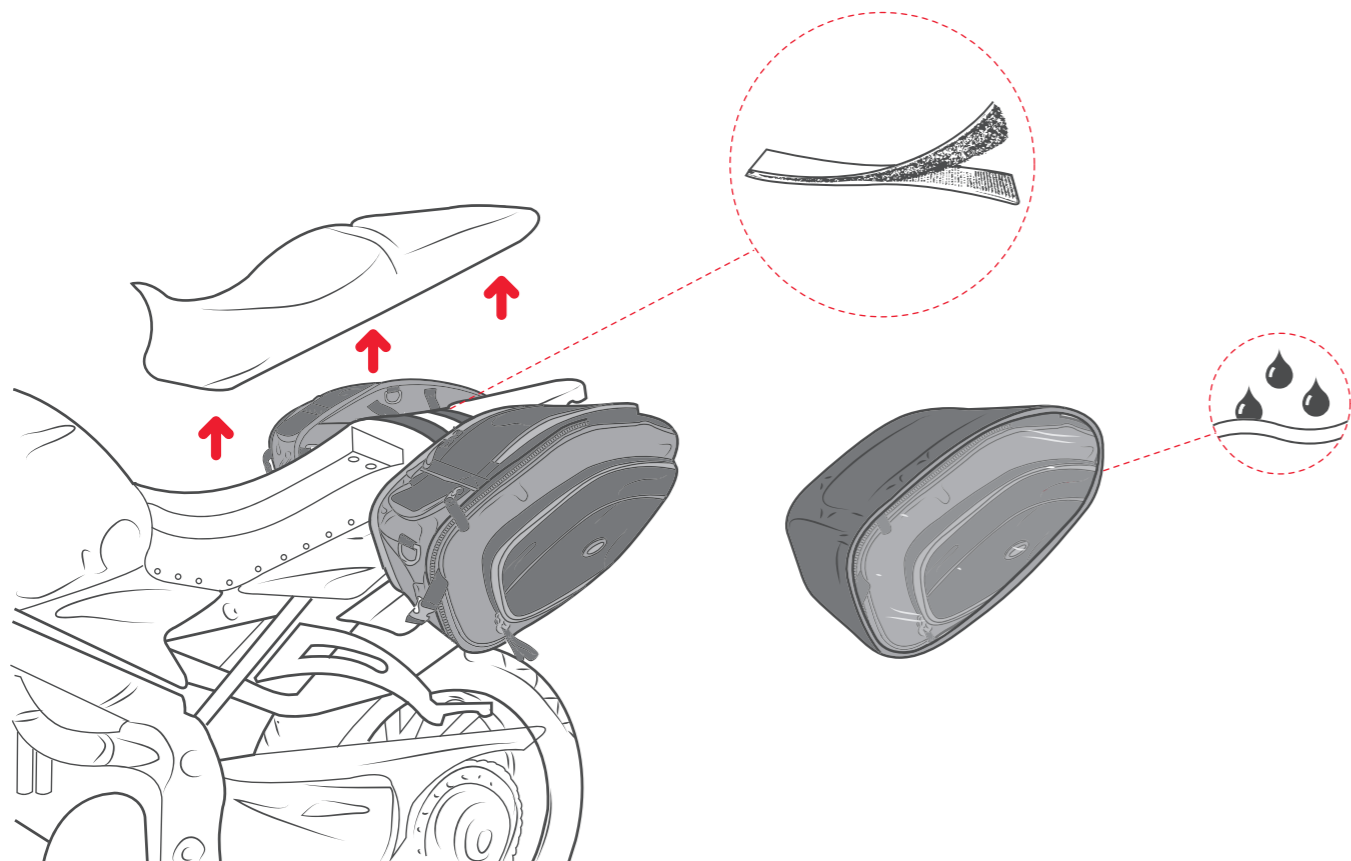

### WARNING:

- Clean the tank of the bike before positioning the Universal Base Tank to avoid scratches in the paint.
- Make sure the bag and its accessories are properly assembled.
- The maximum speed of the motorcycle with the bag full must not exceed 120 km/h (this may vary depending on the legislation of each country).
- When cleaning the bag use water with neutral soap, always avoid using solvents or chemical products.
- SHAD will not hold responsibility for damages caused by an incorrect assembly.

### PRECAUCIÓN:

- Limpiar el depósito de la moto antes de posicionar la "Universal Base Tank" para evitar rayadas en la pintura.
- Asegurarse que la bolsa y todos sus accesorios están correctamente montados.
- La velocidad máxima con una bolsa llena tiene que ser de 120 Km/h (según legislación de cada país).
- Si requiere limpiar las bolsas, utilice agua con jabón neutro, nunca utilice disolventes o productos químicos.
- SHAD no se hará responsable de los daños causados por un incorrecto montaje.

### PRECAUTIONS:

- Nettoyer le réservoir de la moto avant de mettre la "Universal Base Tank" pour éviter des rayures des peintures.
- S'assurer que le sac et tous ses accessoires soient correctement montés.
- La vitesse maximum avec la valise pleine doit être de 120 Km/h (selon la législation de chaque pays).
- Si vous souhaitez laver le sac, utilisez de l'eau avec un savon neutre, ne jamais utiliser des dissolvants ou des produits chimiques.
- SHAD ne se portera pas responsable des dommages causés par un montage incorrect.

### PRECAUZIONI:

- Pulire il serbatoio della moto prima di montare la "Universal Base Tank" per evitare graffi sulla vernice.
- Verificare che la borsa e tutti i suoi accessori siano ben montati.
- La velocità massima col bauletto pieno deve essere di 120 km/h (secondo la legislazione del Paese in cui si viaggia).
- Se necessario, pulire la borsa usando sapone neutro; non usare mai detersivi o prodotti chimici.
- SHAD non sarà responsabile dei danni causati da uno scorretto montaggio.

## MORE SOFT BAGS FROM SHAD



Backpack - SB85



Waist Bag - SBT5



Toll Pass Pouch - SBT4

[www.shad.es](http://www.shad.es)

# SHAD

[www.shad.es](http://www.shad.es)

## SOFT BAGS

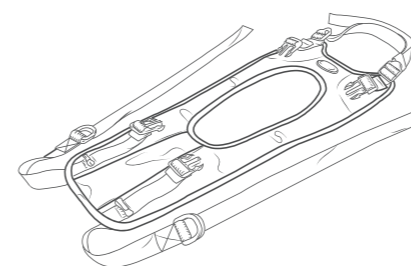

Universal Base Tank  
X1SB90



Tank Bag Enduro  
X0SB23

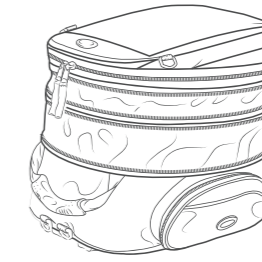

Big Tank Bag  
X0SB35

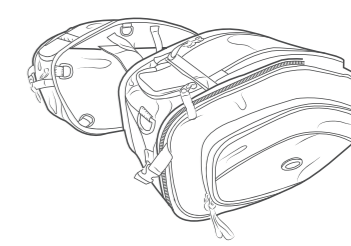

Sports Side Bags  
X0SB44

## Universal Base Tank X1 SB90

1.

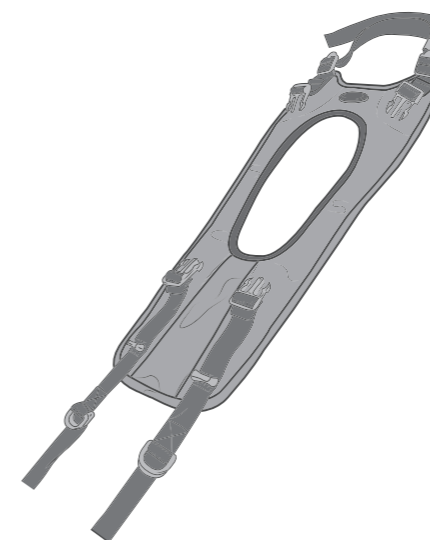

2.

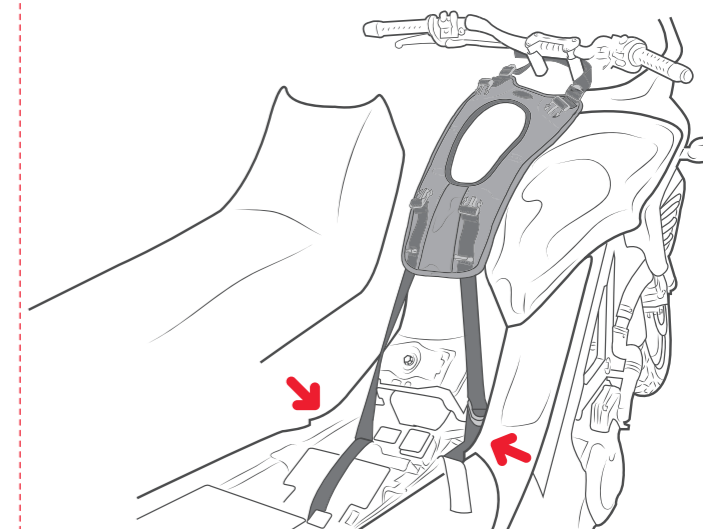

3.

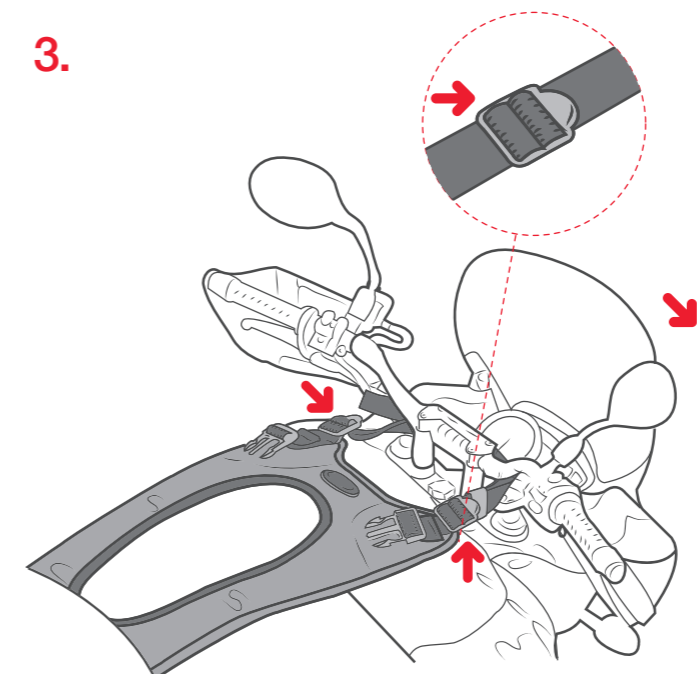

4.

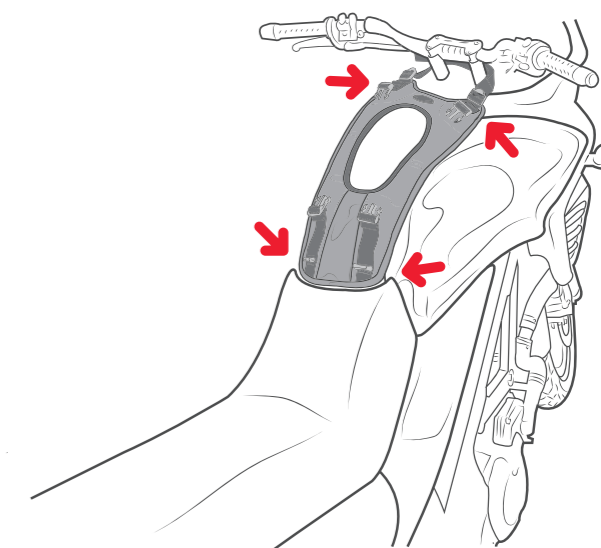

**Enduro Bag**  
X0 SB23

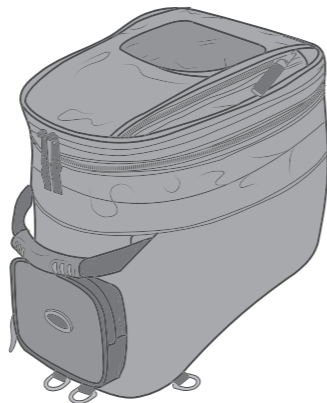
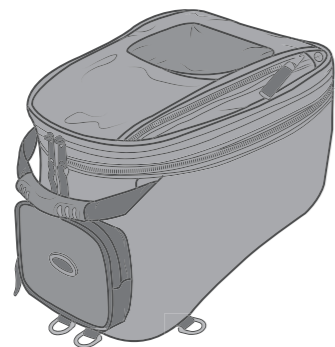
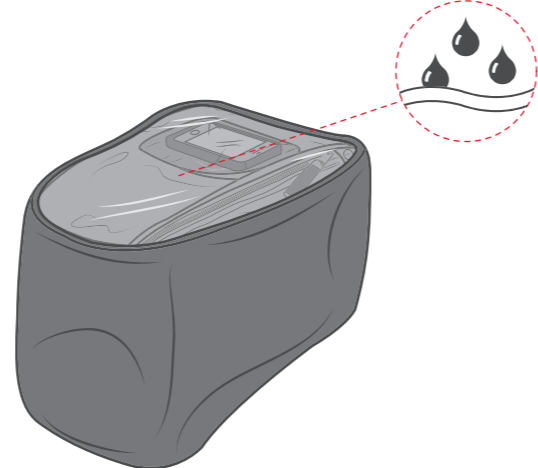
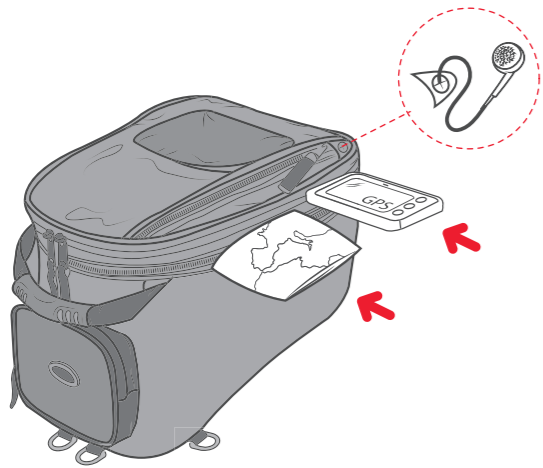
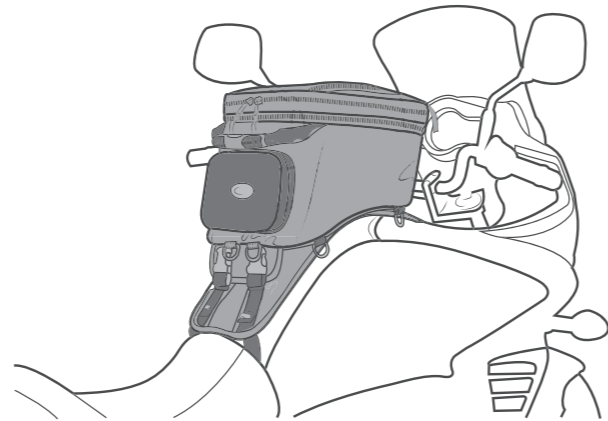
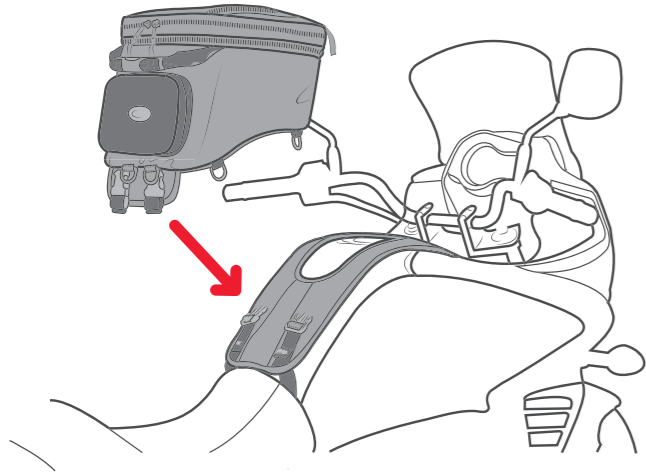

15 L.



23 L.

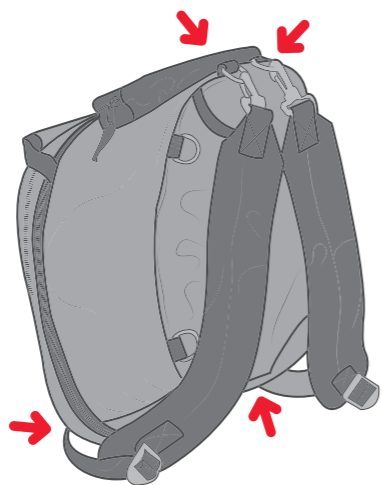

**Big Tank Bag**  
X0 SB35

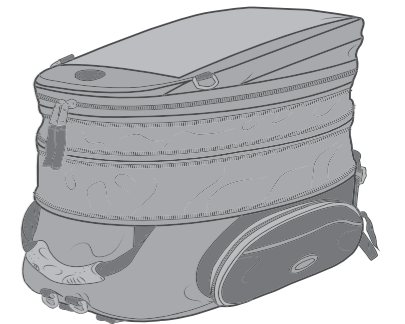
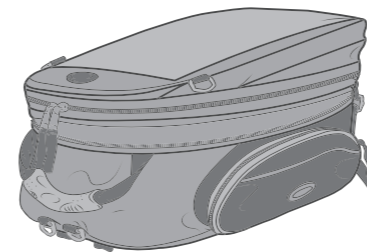
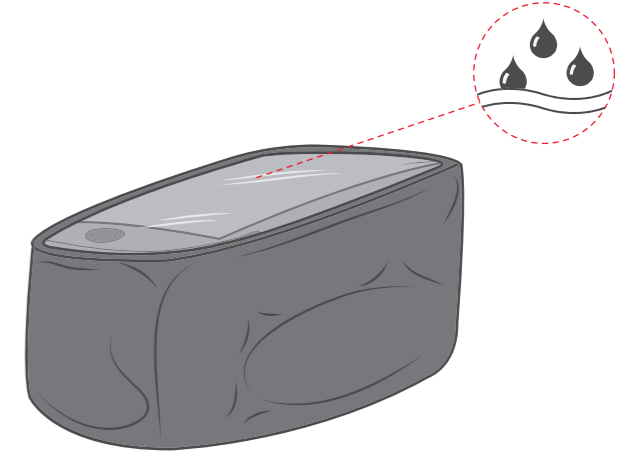
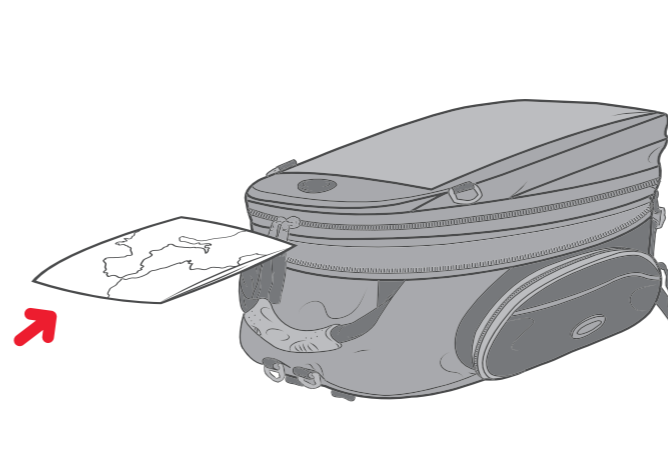
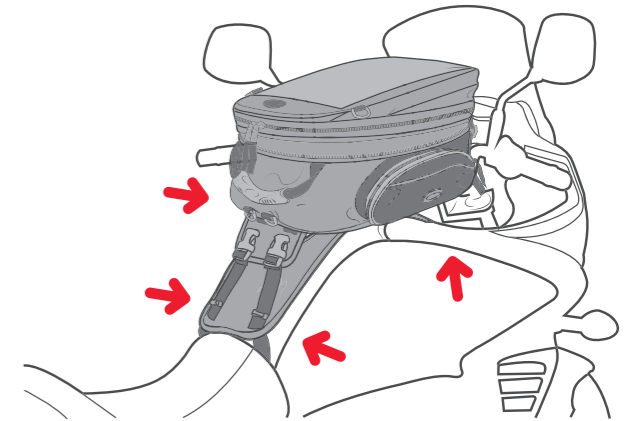
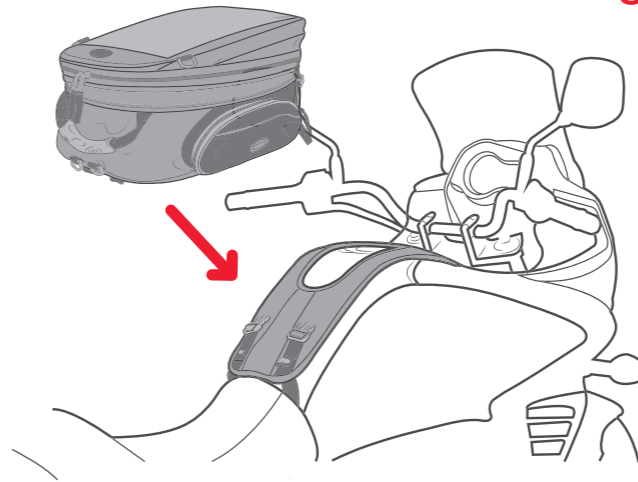

18 L.



40 L.

